

- Home
- Documentation
- Downloads
- Demo
- Tracker
- Development
- Translation
- Moodle.net
- Search

You are here

SCORM settings

Main page ► Managing a Moodle course ► Activities ► SCORM activity ► **SCORM settings**
SCORM activity

- **SCORM settings**
- Using SCORM
- Creating SCORM
Content
- SCORM FAQ

Contents

- 1 Adding a SCORM package
- 2 Course settings
 - 2.1 General
 - 2.1.1 Name
 - 2.1.2 Description
 - 2.1.3 Display description on the course page
 - 2.2 Package
 - 2.2.1 Alias/Shortcut
 - 2.2.2 Selecting an imsmanifest.xml
 - 2.3 Appearance
 - 2.3.1 Display package
 - 2.3.2 Display course structure on entry page
 - 2.3.3 Show Navigation
 - 2.3.4 Display attempt status
 - 2.3.5 Width
 - 2.3.6 Height
 - 2.3.7 Options
 - 2.4 Availability
 - 2.5 Grade
 - 2.5.1 Grading method
 - 2.5.2 Maximum grade
 - 2.6 Attempts management
 - 2.6.1 Number of attempts
 - 2.6.2 Attempts grading
 - 2.6.3 Force new attempt
 - 2.6.4 Lock after final attempt
 - 2.7 Compatibility settings
 - 2.7.1 Auto-Continue
 - 2.7.2 Force completed
 - 2.7.3 Auto commit
 - 2.7.4 Mastery score overrides status
 - 2.8 Common module settings
 - 2.9 Restrict access

- 2.10 Activity completion settings
- 2.11 Save settings
- 3 Site administration settings
 - 3.1 Default Value Settings
 - 3.2 Other Important Settings
- 4 See also

Adding a SCORM package

First - make sure you have created a course (see: [Adding_a_course](#))

Quick method: (*Note - does not work with versions of Internet Explorer earlier than IE10*)

1. Click the 'Turn editing on' button at the top right of the course page
2. Drag and drop the SCORM package zip file onto the course section where you'd like it to appear
3. Answer 'Add a SCORM package' to the popup dialogue asking what you want to do with the zip file then click the upload button
4. If necessary, edit the title of the file by clicking the pencil icon, or edit other options (see below) by clicking the editing icon

Note: It is currently not yet possible to add AICC packages using the quick method.

Longer method:

1. Click the 'Turn editing on' button at the top right of the course page
2. Click the 'Add an activity or resource' link in the section you wish to add your SCORM package, then in the activity chooser, select SCORM package then click the Add button (or select 'SCORM package' from the 'Add an activity' dropdown menu)
3. Enter a name and a description (which may be required or optional according to the admin settings)
4. Either drag and drop a SCORM package zip file into the box with an arrow or click the Add button to open the File picker menu in order to choose a file from your computer or a repository
5. Select display and other options as required (see below)
6. Click the button 'Save and display' at the bottom of the page

You can edit or update the SCORM package later by clicking on the edit icon (usually a hand/pen) or by clicking on its name and then *Settings > SCORM/AICC administration > Edit settings*.

Note: Moodle **does not** generate SCORM content. Moodle presents the content in SCORM packages to learners, and saves data from learner interactions with the SCORM package. See [Tools for creating SCORM content](#)

Course settings

General

Adding a new SCORM package to Language ▶ Expand all

General

Name*

Description*

Paragraph **B** *I* [List] [List] [Link] [Image] [Video] [File]

Path: p

Display description on course page ?

General settings expanded by default

Name

Whatever you type here will form the link learners click on to access the SCORM package, so it is helpful to give it a name that suggests its purpose.

Description

Add a description of your SCORM activity here. Click "Show editing tools" to display the rich text editor, and drag the bottom right of the text box out to expand it.

Display description on the course page

If this box is ticked, the description will appear on the course page just below the name of the SCORM activity.

Package

This setting determines which SCORM package is used by this SCORM activity. Drag and drop or click the icon top left to upload your SCORM package. (Note that you must not unzip the package before upload.) The default (1) is to be able to upload a file. If your admin has added additional options in *Site administration > Plugins > Activity modules > SCORM package* then these will be available in a dropdown menu. (2)

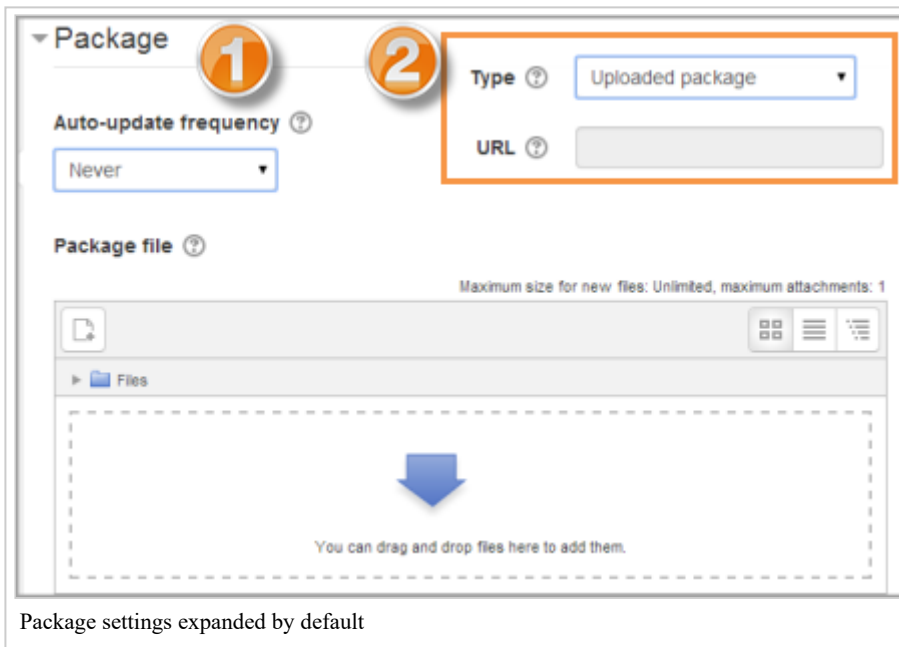

Alias/Shortcut

If you access your SCORM package from a repository (such as File system repository or Private files) you can choose to create an alias/shortcut to it and then set an update frequency to set how often Moodle should check to see if there is an updated zip. (See Working with files for more information on setting an alias/shortcut.)

Selecting an imsmanifest.xml

It is possible to select the imsmanifest.xml file and have it as an alias/shortcut. To do this, you need to have created a File system repository and, when configuring it, allowed relative files. Extract your SCORM package into a folder there. When clicking on the Add button to add your SCORM package, select the file system repository folder with your SCORM package and browse for and select the imsmanifest.xml file, ensuring you the option to create an alias/shortcut to the file. Save and display. (Note this method is only currently supported by the File system repository.)

For more information with screenshots, see Dan Marsden's blog post on Managing SCORM content

Note: The settings (*Type*, *URL* and *Auto-update frequency*) are only available when configured globally. See **Admin settings** below.

Appearance

(These settings are collapsed by default)

▼ Appearance

Display package Current window ▼

Width* 100%

Height* 500

Options (Prevented by some browsers)*

- Allow the window to be scrolled
- Show the directory links
- Show the location bar
- Show the menu bar
- Show the toolbar
- Status

Student skip content structure page* First access ▼

?

Disable preview mode* No ▼

Display course structure on entry page Yes ▼

?

Display course structure in player* To the side ▼

Show Navigation* Floating ▼

From left* 215

From top* 300

Display attempt status My home and entry page ▼

[Show less...](#)

Appearance settings expanded

Display package

Choose from current or new window. Note that if you choose a new window, students need to ensure pop ups are enabled.

Display course structure on entry page

If this is enabled then the table of contents of the package will be displayed when the students clicks to access the package.

Show Navigation

This setting determines whether the navigation buttons are shown or not.

1. No -they are hidden
2. Under content - they are displayed underneath the SCORM package
3. Floating - the navigation buttons are floating (with options to choose the position from the left and top)

Display attempt status

You can choose whether to display a summary of the student's attempts on the entry page, on their Dashboard page or both. This setting is helpful when debugging grading issues - working out why a user got a certain grade.

The following settings become visible when "Show more" is clicked:

Width

Stage size width as a css value, either % or pixels. Default is 100%. You can change to a different percentage by putting a % symbol after the number (ex. 80%). You can also set to a pixels value by entering a number higher than 100 (ex. 800).

Height

Stage size height as a css value, either % or pixels. Default is 500 pixels. You can change to a percentage by putting a % symbol after the number (ex. 80%). You can also set to a pixels value by entering a number higher than 100 (ex. 800).

Options

There is a series of check boxes for: Allow the window to be resized and scrolled, displaying directory links, location bar, menu bar, toolbar and/or status.

- **Student skip content structure page** - never, first access, always
- **Disable preview mode** - If this option is set to Yes, the Preview button in the view page of a SCORM/AICC Package activity will be hidden. The student can choose to preview (browse mode) the activity or attempt it in the normal mode. When a Learning Object is completed in preview (browse) mode, it's marked with browsed icon
- **Display course structure in player**

Availability

(These settings are collapsed by default.)

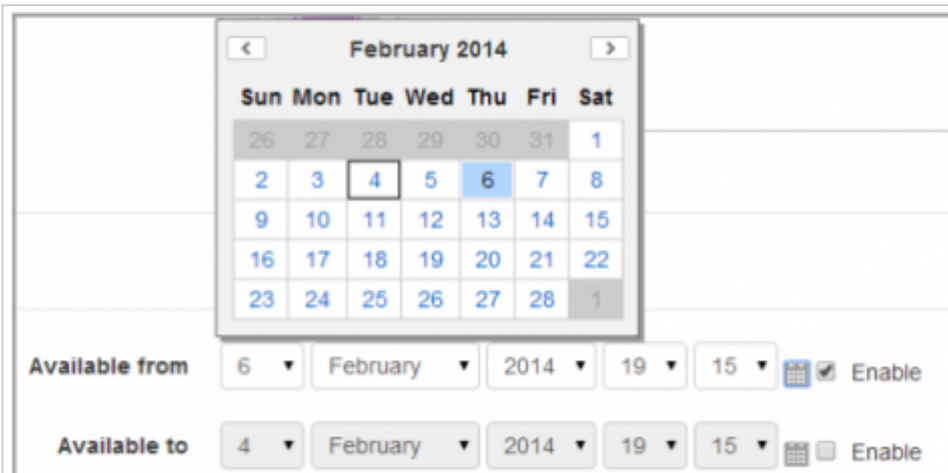

The screenshot shows a user interface for setting availability. At the top, there is a calendar for February 2014. Below the calendar, there are two rows of date pickers. The first row is labeled 'Available from' and has dropdowns for day (6), month (February), year (2014), and time (19:15), followed by a calendar icon and an 'Enable' checkbox. The second row is labeled 'Available to' and has dropdowns for day (4), month (February), year (2014), and time (19:15), followed by a calendar icon and an 'Enable' checkbox. The text 'Availability settings expanded' is visible at the bottom of the interface.

Choose here the dates you wish the SCORM package to be available to students.

Grade

(These settings are collapsed by default)

Grade settings expanded

Grading method

- - Learning Objects - This mode shows the number of completed/passed Learning Objects for the activity. The max value is the number of Package's Learning Objects. *Tip:* If your SCORM package does report cmi.core.lesson_status, and does not report cmi.core.score.raw, then you should use this setting.
 - Highest grade - The grade page will display the highest score obtained by users in all passed Learning Objects. *Tip:* If your SCORM package does report cmi.core.score.raw, and does not report cmi.core.lesson_status, then you should use this setting, Average grade, or Sum grade.
 - Average grade - If you choose this mode Moodle will calculate the average of all scores.
 - Sum grade - With this mode all the scores will be added.

Maximum grade

Not applicable if Grading Method is Learning objects. Usual setting is 100. If your SCO 's high score is something other than 100, you should adjust this value appropriately. When grading Method is one of the score settings, then the gradebook grade is package score divided by this number.

Attempts management

(These settings are collapsed by default.)

Attempts management screen expanded

Number of attempts

Defines the number of attempts permitted to users. It works only with SCORM 1.2 and AICC packages. SCORM2004 has its own max attempts definition.

- - The option to start a new attempt is provided by a checkbox above the **Enter** button on the content structure page, so be sure you're providing access to that page if you want to allow more than one attempt.
 - An attempt is not complete until the cmi.core.lesson_status for the attempt is set to either 'completed' or 'passed'. After that, the **Start new attempt** checkbox is available to the learner.

Attempts grading

When you permit multiple attempts for students, you can choose how to record the result in gradebook by first, last, average or highest settings.

- **Display attempt status** - If enabled, scores and grades for attempts are displayed on the SCORM outline page. This setting makes the block display more info to the user on the entry page to the SCORM and in the course overview block - if you turn it off it will display less info. This setting is helpful when debugging grading issues - working out why a user got a certain grade.

Force new attempt

If this is enabled then every time the student accesses the package, it will count as a new attempt.

Lock after final attempt

If this is enabled then once a student has used up all their attempts, they can no longer access the SCORM package.

Compatibility settings

(These settings are collapsed by default.)

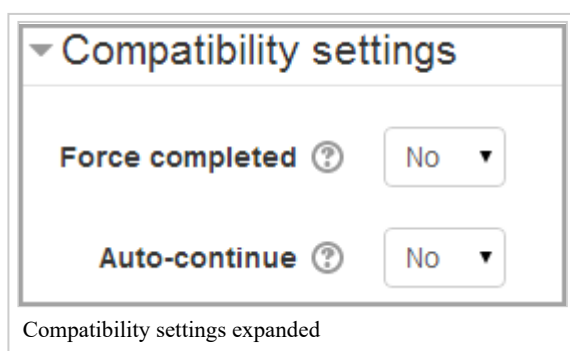

Auto-Continue

For SCORM packages that contain multiple learning objects (or SCO's) and Auto-continue is set to Yes, when a Learning Object calls the "close communication" method the next available object is launched automatically. If it is set to No, the users must use the navigation provided to continue to the next object. Many SCORM packages only contain a single learning object (or SCO) so this setting does not apply.

TIP: If your package contains multiple branches Auto-Continue will only move from one object to the next within the same topic.

Force completed

If this is enabled then the status of the current attempt is set to "complete". Note that this only applies to SCORM 1.2 packages and is useful if the SCORM package does not handle revisiting an attempt correctly, in review or browse mode, or otherwise incorrectly issues the completion status.

Auto commit

Some SCORM packages don't explicitly call Commit() regularly for whatever reason so progress is not stored in the database. This patch will Commit() the data from the SCORM package 60 seconds after the values are set, unless the package Commit(s) sooner.

Mastery score overrides status

If this setting is enabled and a mastery score is provided within your package, when LMSFinish is called and a raw score has been set, if the raw score is lower than the mastery score, the lesson status will be overridden and set to "failed". More information on this behaviour is available in the SCORM FAQ: Moodle changes cmi.core.lesson_status from completed or passed to failed

Common module settings

Group mode and groupings settings are available for SCORM packages in Moodle 3.1 onwards. This means that

- A SCORM package can be restricted to a particular grouping
- SCORM reports may be filtered by group

See Common module settings for more information.

Restrict access

These settings will be available if Conditional activities are enabled.

Activity completion settings

If this has been enabled for the course, then SCORM completion may be set based on minimum score or status (e.g. "Passed").

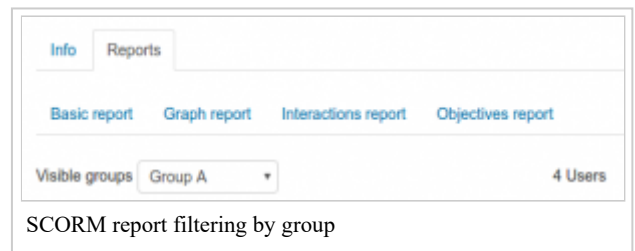

Activity completion

Completion tracking ?

Students can manually mark the activity as completed ▼

Require view Student must view this activity to complete it

Require grade ? Student must receive a grade to complete this activity

Require minimum score ?

0 Disable

Require status ? Passed

Completed

Require all scores to return completion status ?

Expect completed on ?

2 ▼ March ▼ 2018 ▼ Enable

Save settings

As in most activities there are 3 save button choices. **Cancel**, **Save and return to course** and **Save changes** buttons. The Save changes button will take the teacher back to the SCORM "stage" page.

Site administration settings

These options are available to the site admin via *Site administration > Plugins > Activity Modules > SCORM Package*.

Default Value Settings

Many of the settings available in the SCORM Package administration simply set the default value for the SCORM activity module setup options provided within courses. Edit these settings to save yourself time when adding large numbers of packages, or to establish a standard for presentation across the site.

Other Important Settings

The following options provided which **do not** simply set a default value for the SCORM activity editing page view.

Auto-update frequency

If not using a standard SCORM package uploaded using the filepicker and the SCORM package is hosted outside your Moodle installation the option to auto-update the package will be available - you can elect to have the package updated on every entry to the package or daily via the Moodle cron.

Synchronization time

Enable SCORM 1.2 standard mode

If this setting is disabled, then it will be possible to exceed the allowed amount of stored data for SCORM 1.2 packages. Many SCORM packages go over the 4096 characters limit and while SCORM 2004 allows a higher number of characters, it is not supported. This setting will mean users can allow their 1.2 packages to store more data. When disabled it extends the items restricted to 256 and 4096 by the SCORM 1.2 spec to 64000 (the highest value allowed in the SCORM 2004 spec)

Enable external package type

If selected, presents a text field to paste a URL to a remote imsmanifest.xml (in an unzipped remote SCORM package), as well as the file picker option provided by default. Note that the content is played from the designated location, and not unpacked into the Moodle file system. So if the base url is different from your moodle url then browser security will block cross-domain communication and no grades/tracking information will be passed back to Moodle.

Enable downloaded package type

If selected, presents a text field to paste a URL to a remote package.zip SCORM package. Package is downloaded and unzipped into the Moodle file system.

Enable IMS package type

Enables a package to be selected from within an IMS repository

Force users to enable JavaScript

Since the SCORM API uses JavaScript to save data to Moodle, this is a great idea!

Activate API debug and tracing (set the capture mask with apidebugmask)

Turns on debugging for SCORM activities. In Moodle 2 you no longer have to also turn on debugging in the developer options.

API debug capture mask

.* will debug for admin user only: You can use the mask to enable debugging under certain conditions. For example, if you are logged in using the admin user (username admin) you can set the api mask to: **admin.*** Users not logged in as admin will not see the debugging log. The "Default" api mask is .* which translates roughly to **everybody**.

Enable direct AICC url

Makes it easier to connect to externally hosted AICC content as the teacher doesn't have to create an AICC package and is able to link directly to the external AICC url.

Enable external AICC HACP

The SCORM activity can also support external AICC HACP Communication where the AICC package is hosted on an external content providers site and passes back http requests directly from the external server instead of within the users web browser session - this is disabled by default.

AICC pass numeric user id

Protect package downloads.

This is disabled by default, meaning packages can always be downloaded (eg for offline mobile use.) If this is enabled then only users with the capability course:manageactivities can download the package.

See also

- SCORM Schema for developers

Retrieved from "https://docs.moodle.org/38/en/index.php?title=SCORM_settings&oldid=130233"

Category: SCORM

-
- This page was last modified on 2 March 2018, at 21:20.
 - Content is available under GNU General Public License unless otherwise noted.